

### L 100 - 3/8" (9,525 mm)

Caratteristiche Features Merkmale Características	Codice Code symbol Fabriknummer Code symbole Numero de fabrica	Nostro codice Our code Unser code Notre code Nuestro código	Tipo Type Type Tipo	Codice flangia Flange code Bordscheiben-Code Code flasque Código brida	N. denti N. of teeth Zahnezahl N. bre de dents Cantidad de dientes	Dp	De	Df	Dm	Di	F	L	Foro stock Stock bore Vor bohrung Alesage en stock Agujero de stock	Peso Weight / Gewicht Poids / Peso Kg		
Acciaio / Steel / Stahl Acier / Acero	10L100	L100010	6F	FL050	10	30,32	29,56	37,0	20	-	31,8	45	8	0,15		
	11L100	L100011	6F	FL050	11	33,35	32,59	37,0	22	-	31,8	45	8	0,20		
	12L100	L100012	6F	FL052	12	36,38	35,62	43,0	24	-	31,8	45	8	0,26		
	13L100	L100013	6F	FL083	13	39,41	38,65	44,0	28	-	31,8	45	8	0,30		
	14L100	L100014	6F	FL054	14	42,45	41,68	48,0	28	-	31,8	45	11	0,34		
	15L100	L100015	6F	FL055	15	45,48	44,72	51,0	34	-	31,8	45	11	0,45		
	16L100	L100016	6F	FL056	16	48,51	47,75	54,0	36	-	31,8	45	11	0,52		
	17L100	L100017	6F	FL057	17	51,54	50,78	57,0	36	-	31,8	45	11	0,53		
	18L100	L100018	6F	FL058	18	54,57	53,81	60,0	40	-	31,8	45	11	0,62		
	19L100	L100019	6F	FL059	19	57,61	56,84	64,0	40	-	31,8	45	11	0,66		
	20L100	L100020	6F	FL060	20	60,64	59,88	66,5	40	-	31,8	45	11	0,72		
	21L100	L100021	6F	FL061	21	63,67	62,91	70,0	45	-	31,8	45	11	0,77		
	22L100	L100022	6F	FL062	22	66,70	65,94	75,0	45	-	31,8	45	11	0,88		
	23L100	L100023	6F	FL063	23	69,73	68,97	79,0	55	-	31,8	45	11	1,12		
	24L100	L100024	6F	FL063	24	72,77	72,00	79,0	55	-	31,8	45	11	1,13		
	25L100	L100025	6F	FL064	25	75,80	75,04	82,5	58	-	31,8	45	11	1,18		
	26L100	L100026	6F	FL065	26	78,83	78,07	86,0	58	-	31,8	45	11	1,24		
	27L100	L100027	6F	FL065	27	81,86	81,10	86,0	58	-	31,8	45	11	1,35		
	28L100	L100028	6F	FL066	28	84,89	84,13	91,0	58	-	31,8	45	11	1,42		
	29L100	L100029	6F	FL067	29	87,93	87,16	94,0	58	-	31,8	45	11	1,50		
	30L100	L100030	6F	FL068	30	90,96	90,20	97,0	70	-	31,8	45	11	1,61		
	32L100	L100032	6F	FL070	32	97,02	96,25	102,0	70	-	31,8	45	11	1,84		
	33L100	L100033	6F	FL071	33	100,05	99,29	106,0	70	-	31,8	45	11	1,95		
	34L100	L100034	6F	FL072	34	103,08	102,32	112,0	70	-	31,8	45	11	2,10		
	35L100	L100035	6F	FL072	35	106,12	105,35	112,0	70	-	31,8	45	11	2,23		
	36L100	L100036	6F	FL074	36	109,15	108,39	115,0	70	-	31,8	45	11	2,32		
	40L100	L100040	6WF	FL078	40	121,28	120,51	128,0	70	100	31,8	45	11	2,80		
	41L100	L100041	6WF	FL080	41	124,31	123,54	135,0	70	103	31,8	45	11	2,95		
	42L100	L100042	6WF	FL080	42	127,34	126,58	135,0	70	106	31,8	45	11	3,10		
	44L100	L100044	6WF	FL081	44	133,40	132,62	142,0	70	112	31,8	45	11	3,36		
	45L100	L100045	6WF	FL081	45	136,44	135,67	142,0	70	115	31,8	45	11	3,45		
	47L100	L100047	6WF	FL085	47	142,50	141,73	150,0	70	121	31,8	45	11	3,65		
	48L100	L100048	6WF	FL085	48	145,53	144,77	150,0	70	124	31,8	45	11	3,86		
	Ghisa / Cast iron / Grauguss Fonte / Hierro fundido	49L100	L100049	6W	-	49	148,56	147,80	-	70	127	31,8	45	14	2,40	
		50L100	L100050	6W	-	50	151,60	150,83	-	70	130	31,8	45	14	2,50	
		52L100	L100052	6W	-	52	157,66	156,90	-	70	136	31,8	45	14	2,70	
		56L100	L100056	6W	-	56	169,79	169,02	-	70	149	31,8	45	14	2,91	
		57L100	L100057	6W	-	57	172,82	172,06	-	70	152	31,8	45	14	3,10	
		60L100	L100060	6W	-	60	181,91	181,15	-	75	160	31,8	50	14	3,55	
		65L100	L100065	6A	-	65	197,07	196,31	-	75	176	31,8	50	14	4,00	
		66L100	L100066	6A	-	66	200,11	199,34	-	75	179	31,8	50	14	4,15	
		72L100	L100072	6A	-	72	218,30	217,53	-	75	197	31,8	50	14	5,00	
		84L100	L100084	6A	-	84	254,68	253,92	-	75	233	31,8	50	14	6,30	
		90L100	L100090	6A	-	90	272,87	272,11	-	75	252	31,8	50	14	7,50	
		96L100	L100096	6A	-	96	291,06	290,30	-	75	269	31,8	50	14	8,20	
		120L100	L100120	6A	-	120	363,83	363,07	-	75	342	31,8	50	14	11,50	
		senza flangia / without flanges ohne Flanschen / sans flasques sin tapetas	49H075	H075014	6F	FL059	14	56,60	55,22	64,0	40	-	26,4	40	8	0,59
			15H075	H075015	6F	FL060	15	60,64	59,27	66,5	45	-	26,4	40	8	0,65
16H075			H075016	6F	FL061	16	64,68	63,31	70,0	45	-	26,4	40	8	0,70	
17H075			H075017	6F	FL062	17	68,72	67,35	75,0	45	-	26,4	40	8	0,73	
18H075			H075018	6F	FL063	18	72,77	71,39	79,0	55	-	26,4	40	11	0,91	
19H075			H075019	6F	FL064	19	76,81	75,44	82,5	60	-	26,4	40	11	1,08	
20H075	H075020		6F	FL076	20	80,85	79,48	87,0	62	-	26,4	40	11	1,18		
21H075	H075021		6F	FL066	21	84,89	83,52	91,0	65	-	26,4	40	11	1,30		
22H075	H075022		6F	FL067	22	88,94	87,56	94,0	68	-	26,4	40	11	1,42		
23H075	H075023		6F	FL068	23	92,98	91,61	97,0	72	-	26,4	40	11	1,67		
24H075	H075024		6F	FL070	24	97,02	95,65	102,0	72	-	26,4	40	11	1,71		
25H075	H075025		6F	FL071	25	101,06	99,69	106,0	72	-	26,4	40	11	1,87		
26H075	H075026	6F	FL072	26	105,11	103,73	112,0	80	-	26,4	40	11	2,00			
27H075	H075027	6F	FL074	27	109,15	107,78	115,0	80	-	26,4	40	11	2,10			
28H075	H075028	6F	FL075	28	113,19	111,82	120,0	80	-	26,4	40	11	2,26			
29H075	H075029	6F	FL075	29	117,23	115,86	120,0	80	-	26,4	40	11	2,49			
30H075	H075030	6F	FL078	30	121,28	119,90	128,0	80	-	26,4	40	11	2,70			
32H075	H075032	6F	FL080	32	129,36	127,99	135,0	80	-	26,4	40	11	2,85			
33H075	H075033	6F	FL081	33	133,40	132,03	142,0	80	-	26,4	40	11	3,10			
34H075	H075034	6F	FL081	34	137,45	136,07	142,0	80	-	26,4	40	11	3,30			
35H075	H075035	6F	FL085	35	141,49	140,12	150,0	80	-	26,4	40	11	3,50			
36H075	H075036	6F	FL085	36	145,53	144,16	150,0	80	-	26,4	40	11	3,65			
38H075	H075038	6F	FL086	38	153,62	152,24	158,0	80	-	26,4	40	11	3,90			
40H075	H075040	6F	FL090	40	161,70	160,33	168,0	80	-	26,4	40	11	4,23			
42H075	H075042	6F	FL094	42	169,79	168,41	180,0	80	-	26,4	40	11	4,80			
senza flangia / without flanges ohne Flanschen / sans flasques sin tapetas	44H075	H075044	6WF	FL095	44	177,87	176,50	184,0	80	150	26,4	40	14	5,20		
	45H075	H075045	6WF	FL096	45	181,91	180,54	192,0	80	154	26,4	40	14	5,45		
	48H075	H075048	6WF	FL100	48	194,04	192,67	200,0	90	166	26,4	45	14	4,30		
	49H075	H075049	6W	-	49	198,08	196,71	-	90	170	26,4	45	14	4,50		
50H075	H075050	6W	-	50	202,13	200,75	-	90	174	26,4	45	14	4,66			

### H 075 - 1/2" (12,75 mm)

Caratteristiche Features Merkmale Características	Codice Code symbol Fabriknummer Code symbole Numero de fabrica	Nostro codice Our code Unser code Notre code Nuestro código	Tipo Type Type Tipo	Codice flangia Flange code Bordscheiben-Code Code flasque Código brida	N. denti N. of teeth Zahnezahl N. bre de dents Cantidad de dientes	Dp	De	Df	Dm	Di	F	L	Foro stock Stock bore Vor bohrung Alesage en stock Agujero de stock	Peso Weight / Gewicht Poids / Peso Kg
Acciaio / Steel / Stahl Acier / Acero	14H075	H075014	6F	FL059	14	56,60	55,22	64,0	40	-	26,4	40	8	0,59
	15H075	H075015	6F	FL060	15	60,64	59,27	66,5	45	-	26,4	40	8	0,65
	16H075	H075016	6F	FL061	16	64,68	63,31	70,0	45	-	26,4	40	8	0,70
	17H075	H075017	6F	FL062	17	68,72	67,35	75,0	45	-	26,4	40	8	0,73
	18H075	H075018	6F	FL063	18	72,77	71,39	79,0	55	-	26,4	40	11	0,91
	19H075	H075019	6F	FL064	19	76,81	75,44	82,5	60	-	26,4	40	11	1,08
	20H075	H075020	6F	FL076	20	80,85	79,48	87,0	62	-	26,4	40	11	1,18
	21H075	H075021	6F	FL066	21	84,89	83,52	91,0	65	-	26,4	40	11	1,30
	22H075	H075022	6F	FL067	22	88,94	87,56	94,0	68	-	26,4	40	11	1,42
	23H075	H075023	6F	FL068	23	92,98	91,61	97,0	72	-	26,4	40	11	1,67
	24H075	H075024	6F	FL070	24	97,02	95,65	102,0	72	-	26,4	40	11	1,71
	25H075	H075025	6F	FL071	25	101,06	99,69	106,0	72	-	26,4	40	11	1,87
	26H075	H075026	6F	FL072	26	105,11	103,73	112,0	80	-	26,4	40	11	2,00
	27H075	H075027	6F	FL074	27	109,15	107,78							

H 100 - 1/2" (12,75 mm)

Caratteristiche Features Merkmale Características Características	Codice Code symbol Fabriknummer Code symbole Numero de fabrica	Nostro codice Our code Unser code Notre code Nuestro código	Tipo Type Typ Type Tipo	Codice flangia Flange code Bordscheiben-Code Code flasque Código brida	N. denti N. of teeth Zahnezahl N. bre de dents Cantidad de dientes	Dp	De	Df	Dm	Di	F	L	Foro stock Stock bore Vorbohrung Alesage en stock Agujero de stock	Peso Weight / Gewicht Poids / Peso Kg
Acciaio / Steel / Stahl Acier / Acero	14H100	H100014	6F	FL059	14	56,60	55,22	64,0	40	-	31,8	45	11	0,67
	15H100	H100015	6F	FL060	15	60,64	59,27	66,5	45	-	31,8	45	11	0,77
	16H100	H100016	6F	FL061	16	64,68	63,31	70,0	45	-	31,8	45	11	0,88
	17H100	H100017	6F	FL062	17	68,72	67,35	75,0	45	-	31,8	45	11	0,88
	18H100	H100018	6F	FL063	18	72,77	71,39	79,0	55	-	31,8	45	14	1,06
	19H100	H100019	6F	FL064	19	76,81	75,44	82,5	60	-	31,8	45	14	1,23
	20H100	H100020	6F	FL076	20	80,85	79,48	87,0	62	-	31,8	45	14	1,33
	21H100	H100021	6F	FL066	21	84,89	83,52	91,0	65	-	31,8	45	14	1,43
	22H100	H100022	6F	FL067	22	88,94	87,56	94,0	68	-	31,8	45	14	1,63
	23H100	H100023	6F	FL068	23	92,98	91,61	97,0	72	-	31,8	45	14	1,85
	24H100	H100024	6F	FL070	24	97,02	95,65	102,0	72	-	31,8	45	14	1,93
	25H100	H100025	6F	FL071	25	101,06	99,69	106,0	72	-	31,8	45	14	2,07
	26H100	H100026	6F	FL072	26	105,11	103,73	112,0	80	-	31,8	45	14	2,30
	27H100	H100027	6F	FL074	27	109,15	107,78	115,0	80	-	31,8	45	14	2,40
	28H100	H100028	6F	FL075	28	113,19	111,82	120,0	80	-	31,8	45	14	2,53
	29H100	H100029	6F	FL075	29	117,23	115,86	120,0	80	-	31,8	45	14	2,70
	30H100	H100030	6F	FL078	30	121,28	119,90	128,0	80	-	31,8	45	14	2,93
	32H100	H100032	6F	FL080	32	129,36	127,99	135,0	80	-	31,8	45	14	3,06
	33H100	H100033	6F	FL081	33	133,40	132,03	142,0	80	-	31,8	45	14	3,40
	34H100	H100034	6F	FL081	34	137,45	136,07	142,0	80	-	31,8	45	14	3,57
	35H100	H100035	6F	FL085	35	141,49	140,12	150,0	80	-	31,8	45	14	3,80
	36H100	H100036	6WF	FL085	36	145,53	144,16	150,0	80	118	31,8	45	14	3,92
	38H100	H100038	6WF	FL086	38	153,62	152,24	158,0	80	123	31,8	45	14	4,40
	40H100	H100040	6WF	FL090	40	161,70	160,33	168,0	80	134	31,8	45	14	4,95
	42H100	H100042	6WF	FL094	42	169,79	168,41	180,0	80	140	31,8	45	14	5,60
	Ghisa / Cast iron / Grauguss Fonte / Hierro fundido	44H100	H100044	6WF	FL095	44	177,87	176,50	184,0	80	150	31,8	50	14
45H100		H100045	6WF	FL096	45	181,91	180,54	192,0	80	154	31,8	50	14	6,45
48H100		H100048	6WF	FL100	48	194,04	192,67	200,0	90	166	31,8	50	14	5,30
49H100		H100049	6W	-	49	198,08	196,71	-	90	170	31,8	50	19	5,40
50H100		H100050	6W	-	50	202,13	200,75	-	90	174	31,8	50	19	5,50
52H100		H100052	6W	-	52	210,21	208,84	-	90	182	31,8	50	19	5,80
58H100		H100058	6A	-	58	234,47	233,09	-	90	207	31,8	50	19	6,20
60H100		H100060	6A	-	60	242,55	241,18	-	90	215	31,8	50	19	7,50
70H100		H100070	6A	-	70	282,98	281,61	-	100	255	31,8	55	19	8,20
72H100		H100072	6A	-	72	291,06	289,69	-	100	263	31,8	55	19	9,00
82H100		H100082	6A	-	82	331,49	330,12	-	100	304	31,8	55	19	9,20
84H100		H100084	6A	-	84	339,57	338,20	-	100	312	31,8	55	19	10,00
94H100		H100094	6A	-	94	380,00	378,63	-	120	352	31,8	60	19	13,00
96H100		H100096	6A	-	96	388,08	386,71	-	120	360	31,8	60	19	13,80
106H100		H100106	6A	-	106	428,51	427,14	-	120	401	31,8	60	19	15,50
116H100		H100116	6A	-	116	468,93	467,56	-	120	441	31,8	60	19	18,00
118H100		H100118	6A	-	118	477,02	475,65	-	120	449	31,8	60	19	20,00
120H100		H100120	6A	-	120	485,10	483,73	-	120	458	31,8	60	19	22,00
150H100		H100150	6A	-	150	606,38	605,01	-	120	579	31,8	60	19	25,00
152H100		H100152	6A	-	152	614,47	613,09	-	120	587	31,8	60	19	26,00
154H100		H100154	6A	-	154	622,55	621,18	-	120	595	31,8	60	19	27,00
156H100		H100156	6A	-	156	630,64	629,26	-	120	603	31,8	60	19	28,00

H 150 - 1/2" (12,75 mm)

Caratteristiche Features Merkmale Características Características	Codice Code symbol Fabriknummer Code symbole Numero de fabrica	Nostro codice Our code Unser code Notre code Nuestro código	Tipo Type Typ Type Tipo	Codice flangia Flange code Bordscheiben-Code Code flasque Código brida	N. denti N. of teeth Zahnezahl N. bre de dents Cantidad de dientes	Dp	De	Df	Dm	Di	F	L	Foro stock Stock bore Vorbohrung Alesage en stock Agujero de stock	Peso Weight / Gewicht Poids / Peso Kg
Acciaio / Steel / Stahl Acier / Acero	14H150	H150014	6F	FL059	14	56,60	55,22	64,0	40	-	46,0	58	11	0,91
	15H150	H150015	6F	FL060	15	60,64	59,27	66,5	45	-	46,0	58	11	0,99
	16H150	H150016	6F	FL061	16	64,68	63,31	70,0	45	-	46,0	58	11	1,08
	17H150	H150017	6F	FL062	17	68,72	67,35	75,0	45	-	46,0	58	11	1,15
	18H150	H150018	6F	FL063	18	72,77	71,39	79,0	55	-	46,0	58	14	1,45
	19H150	H150019	6F	FL064	19	76,81	75,44	82,5	60	-	46,0	58	14	1,55
	20H150	H150020	6F	FL076	20	80,85	79,48	87,0	62	-	46,0	58	14	1,66
	21H150	H150021	6F	FL066	21	84,89	83,52	91,0	65	-	46,0	58	14	1,87
	22H150	H150022	6F	FL067	22	88,94	87,56	94,0	68	-	46,0	58	14	2,07
	23H150	H150023	6F	FL068	23	92,98	91,61	97,0	72	-	46,0	58	14	2,28
	24H150	H150024	6F	FL070	24	97,02	95,65	102,0	72	-	46,0	58	14	2,50
	25H150	H150025	6F	FL071	25	101,06	99,69	106,0	72	-	46,0	58	14	2,71
	26H150	H150026	6F	FL072	26	105,11	103,73	112,0	80	-	46,0	58	14	2,99
	27H150	H150027	6F	FL074	27	109,15	107,78	115,0	80	-	46,0	58	14	3,15
	28H150	H150028	6F	FL075	28	113,19	111,82	120,0	80	-	46,0	58	14	3,39
	29H150	H150029	6F	FL075	29	117,23	115,86	120,0	80	-	46,0	58	14	3,57
	30H150	H150030	6F	FL078	30	121,28	119,90	128,0	80	-	46,0	58	14	3,86
	32H150	H150032	6F	FL080	32	129,36	127,99	135,0	80	-	46,0	58	14	4,37
	33H150	H150033	6F	FL081	33	133,40	132,03	142,0	80	-	46,0	58	14	4,66
	34H150	H150034	6F	FL081	34	137,45	136,07	142,0	80	-	46,0	58	14	4,98
	35H150	H150035	6F	FL085	35	141,49	140,12	150,0	80	-	46,0	58	14	5,30
	36H150	H150036	6WF	FL085	36	145,53	144,16	150,0	80	118	46,0	58	14	5,50
	38H150	H150038	6WF	FL086	38	153,62	152,24	158,0	80	126	46,0	58	14	6,10
	40H150	H150040	6WF	FL090	40	161,70	160,33	168,0	80	134	46,0	58	14	6,80
	42H150	H150042	6WF	FL094	42	169,79	168,41	180,0	80	140	46,0	58	19	7,60
	Ghisa / Cast iron / Grauguss Fonte / Hierro fundido	44H150	H150044	6WF	FL095	44	177,87	176,50	184,0	80	150	46,0	58	19
45H150		H150045	6WF	FL096	45	181,91	180,54	192,0	80	154	46,0	58	19	9,00
48H150		H150048	6WF	FL100	48	194,04	192,67	200,0	90	166	46,0	65	19	6,70
49H150		H150049	6W	-	49	198,08	196,71	-	90	170	46,0	65	19	7,00
50H150		H150050	6W	-	50	202,13	200,75	-	90	174	46,0	65	19	7,10
52H150		H150052	6W	-	52	210,21	208,84	-	90	182	46,0	65	19	7,30
58H150		H150058	6A	-	58	234,47	233,09	-	90	207	46,0	65	19	8,10
60H150		H150060	6A	-	60	242,55	241,18	-	90	215	46,0	65	19	9,00
70H150		H150070	6A	-	70	282,98	281,61	-	100	255	46,0	65	24	10,50
72H150		H150072	6A	-	72	291,06	289,69	-	100	263	46,0	65	24	11,00
82H150		H150082	6A	-	82	331,49	330,12	-	100	304	46,0	65	24	12,00
84H150		H150084	6A	-	84	339,57	338,20	-	100	312	46,0	65	24	13,00
94H150		H150094	6A	-	94	380,00	378,63	-	120	352	46,0	65	24	16,00
96H150		H150096	6A	-	96	388,08	386,71	-	120	360	46,0	65	24	17,00
106H150		H150106	6A	-	106	428,51	427,14	-	120	401	46,0	65	24	19,50
116H150		H150116	6A	-	116	468,93	467,56	-	120	441	46,0	65	24	22,00
118H150		H150118	6A	-	118	477,02	475,65	-	120	449	46,0	65	24	23,50
120H150		H150120	6A	-	120	485,10	483,73	-	120	458	46,0	65	24	25,00
150H150		H150150	6A	-	150	606,38	605,01	-	120	579	46,0	65	24	31,50
152H150		H150152	6A	-	152	614,47								

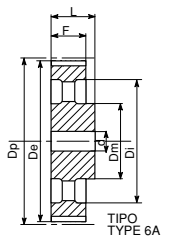
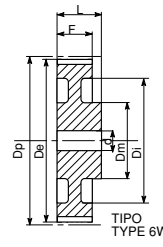
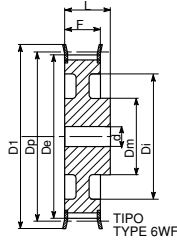
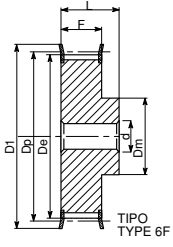

### H 200 - 1/2" (12,75 mm)

Caratteristiche / Features / Merkmale / Características	Codice / Code symbol / Fabriksnummer / Code symbole / Numero de fabrica	Nostro codice / Our code / Unser code / Notre code / Nuestro codigo	Tipo / Type / Typ / Type / Tipo	Codice flangia / Flange code / Bordscheiben-Code / Code flasque / Código brida	N. denti / N. of teeth / Zahnezahl / N. bre de dents / Cantidad de dientes	Dp	De	Df	Dm	Di	F	L	Foro stock / Stock bore / Vorbohrung / Alesage en stock / Agujero de stock	Peso / Weight / Gewicht / Poids / Peso / Kg	
Acciaio / Steel / Stahl / Acero	con flangia / with flanges / mit Flanges / avec flasques / con tapetas	14H200	H200014	6F	FL059	14	56,60	55,22	64,0	40	-	58,7	70	11	1,13
		15H200	H200015	6F	FL060	15	60,64	59,27	66,5	45	-	58,7	70	11	1,21
		16H200	H200016	6F	FL061	16	64,68	63,31	70,0	45	-	58,7	70	11	1,30
		17H200	H200017	6F	FL062	17	68,72	67,35	75,0	45	-	58,7	70	11	1,45
		18H200	H200018	6F	FL063	18	72,77	71,39	79,0	55	-	58,7	70	14	1,65
		19H200	H200019	6F	FL064	19	76,81	75,44	82,5	60	-	58,7	70	14	1,90
		20H200	H200020	6F	FL076	20	80,85	79,48	87,0	62	-	58,7	70	14	2,11
		21H200	H200021	6F	FL066	21	84,89	83,52	91,0	65	-	58,7	70	14	2,23
		22H200	H200022	6F	FL067	22	88,94	87,56	94,0	68	-	58,7	70	14	2,45
		23H200	H200023	6F	FL068	23	92,98	91,61	97,0	72	-	58,7	70	14	2,71
		24H200	H200024	6F	FL070	24	97,02	95,65	102,0	72	-	58,7	70	14	2,97
		25H200	H200025	6F	FL071	25	101,06	99,69	106,0	72	-	58,7	70	14	3,32
		26H200	H200026	6F	FL072	26	105,11	103,73	112,0	80	-	58,7	70	14	3,61
		27H200	H200027	6F	FL074	27	109,15	107,78	115,0	80	-	58,7	70	14	3,90
		28H200	H200028	6F	FL075	28	113,19	111,82	120,0	80	-	58,7	70	14	4,10
		29H200	H200029	6F	FL078	29	117,23	115,86	120,0	80	-	58,7	70	14	4,42
		30H200	H200030	6F	FL078	30	121,28	119,90	128,0	80	-	58,7	70	14	4,74
		32H200	H200032	6F	FL080	32	129,36	127,99	135,0	80	-	58,7	70	14	5,60
		33H200	H200033	6F	FL081	33	133,40	132,03	142,0	80	-	58,7	70	14	5,90
34H200	H200034	6F	FL081	34	137,45	136,07	142,0	80	-	58,7	70	14	6,20		
35H200	H200035	6F	FL085	35	141,49	140,12	150,0	80	-	58,7	70	14	6,60		
36H200	H200036	6WF	FL085	36	145,53	144,16	150,0	80	118	58,7	70	14	7,10		
38H200	H200038	6WF	FL086	38	153,62	152,24	158,0	80	126	58,7	70	14	7,80		
40H200	H200040	6WF	FL090	40	161,70	160,33	168,0	80	134	58,7	70	14	8,40		
42H200	H200042	6WF	FL094	42	169,79	168,41	180,0	80	140	58,7	70	19	9,70		
44H200	H200044	6WF	FL095	44	177,87	176,50	184,0	80	150	58,7	70	19	10,50		
45H200	H200045	6WF	FL096	45	181,91	180,54	192,0	80	154	58,7	70	19	11,30		
48H200	H200048	6WF	FL100	48	194,04	192,67	200,0	90	166	58,7	75	24	8,60		
49H200	H200049	6W	-	49	198,08	196,71	-	90	170	58,7	75	24	7,60		
50H200	H200050	6W	-	50	202,13	200,75	-	90	174	58,7	75	24	8,30		
52H200	H200052	6W	-	52	210,21	208,84	-	90	182	58,7	75	24	8,50		
58H200	H200058	6A	-	58	234,47	233,09	-	90	207	58,7	75	24	10,00		
60H200	H200060	6A	-	60	242,55	241,18	-	90	215	58,7	75	24	11,00		
70H200	H200070	6A	-	70	282,98	281,61	-	100	255	58,7	75	28	12,50		
72H200	H200072	6A	-	72	291,06	289,69	-	100	263	58,7	75	28	14,00		
82H200	H200082	6A	-	82	331,49	330,12	-	100	304	58,7	75	28	13,50		
84H200	H200084	6A	-	84	339,57	338,20	-	100	312	58,7	75	28	15,00		
94H200	H200094	6A	-	94	380,00	378,63	-	120	352	58,7	75	28	18,90		
96H200	H200096	6A	-	96	388,08	386,71	-	120	360	58,7	75	28	20,30		
106H200	H200106	6A	-	106	428,51	427,14	-	120	401	58,7	75	28	22,50		
116H200	H200116	6A	-	116	468,93	467,56	-	120	441	58,7	75	28	24,70		
118H200	H200118	6A	-	118	477,02	475,65	-	120	449	58,7	75	28	26,00		
120H200	H200120	6A	-	120	485,10	483,73	-	120	458	58,7	75	28	28,00		
150H200	H200150	6A	-	150	606,38	605,01	-	120	579	58,7	75	28	32,50		
152H200	H200152	6A	-	152	614,47	613,09	-	120	587	58,7	75	28	35,00		
154H200	H200154	6A	-	154	622,55	621,18	-	120	595	58,7	75	28	38,00		
156H200	H200156	6A	-	156	630,64	629,26	-	120	603	58,7	75	28	41,00		

### H 300 - 1/2" (12,75 mm)

Caratteristiche / Features / Merkmale / Características	Codice / Code symbol / Fabriksnummer / Code symbole / Numero de fabrica	Nostro codice / Our code / Unser code / Notre code / Nuestro codigo	Tipo / Type / Typ / Type / Tipo	Codice flangia / Flange code / Bordscheiben-Code / Code flasque / Código brida	N. denti / N. of teeth / Zahnezahl / N. bre de dents / Cantidad de dientes	Dp	De	Df	Dm	Di	F	L	Foro stock / Stock bore / Vorbohrung / Alesage en stock / Agujero de stock	Peso / Weight / Gewicht / Poids / Peso / Kg	
Acciaio / Steel / Stahl / Acero	con flangia / with flanges / mit Flanges / avec flasques / con tapetas	14H300	H300014	6F	FL059	14	56,60	55,22	64,0	40	-	85,7	100	11	1,35
		15H300	H300015	6F	FL060	15	60,64	59,27	66,5	45	-	85,7	100	11	1,55
		16H300	H300016	6F	FL061	16	64,68	63,31	70,0	45	-	85,7	100	11	1,80
		17H300	H300017	6F	FL062	17	68,72	67,35	75,0	45	-	85,7	100	11	2,10
		18H300	H300018	6F	FL063	18	72,77	71,39	79,0	55	-	85,7	100	19	2,38
		19H300	H300019	6F	FL064	19	76,81	75,44	82,5	60	-	85,7	100	19	2,64
		20H300	H300020	6F	FL076	20	80,85	79,48	87,0	62	-	85,7	100	19	3,10
		21H300	H300021	6F	FL066	21	84,89	83,52	91,0	65	-	85,7	100	19	3,32
		22H300	H300022	6F	FL067	22	88,94	87,56	94,0	68	-	85,7	100	19	3,67
		23H300	H300023	6F	FL068	23	92,98	91,61	97,0	72	-	85,7	100	19	4,00
		24H300	H300024	6F	FL070	24	97,02	95,65	102,0	72	-	85,7	100	19	4,40
		25H300	H300025	6F	FL071	25	101,06	99,69	106,0	72	-	85,7	100	19	4,79
		26H300	H300026	6F	FL072	26	105,11	103,73	112,0	80	-	85,7	100	19	5,20
		27H300	H300027	6F	FL074	27	109,15	107,78	115,0	80	-	85,7	100	19	5,60
		28H300	H300028	6F	FL075	28	113,19	111,82	120,0	80	-	85,7	100	19	5,60
		29H300	H300029	6F	FL078	29	117,23	115,86	120,0	80	-	85,7	100	19	6,00
		30H300	H300030	6F	FL078	30	121,28	119,90	128,0	80	-	85,7	100	19	7,00
		32H300	H300032	6F	FL080	32	129,36	127,99	135,0	80	-	85,7	100	19	7,80
		33H300	H300033	6F	FL081	33	133,40	132,03	142,0	80	-	85,7	100	19	8,70
34H300	H300034	6F	FL081	34	137,45	136,07	142,0	80	-	85,7	100	19	9,70		
35H300	H300035	6F	FL085	35	141,49	140,12	150,0	80	-	85,7	100	19	9,80		
36H300	H300036	6WF	FL085	36	145,53	144,16	150,0	80	118	85,7	100	19	9,90		
38H300	H300038	6WF	FL086	38	153,62	152,24	158,0	80	126	85,7	100	19	11,00		
40H300	H300040	6WF	FL090	40	161,70	160,33	168,0	80	134	85,7	100	19	12,20		
42H300	H300042	6WF	FL094	42	169,79	168,41	180,0	80	140	85,7	100	24	13,80		
44H300	H300044	6WF	FL095	44	177,87	176,50	184,0	80	150	85,7	100	24	15,00		
45H300	H300045	6WF	FL096	45	181,91	180,54	192,0	80	154	85,7	100	24	15,20		
48H300	H300048	6WF	FL100	48	194,04	192,67	200,0	90	166	85,7	100	24	11,40		
49H300	H300049	6W	-	49	198,08	196,71	-	90	170	85,7	100	24	9,40		
50H300	H300050	6W	-	50	202,13	200,75	-	90	174	85,7	100	24	10,60		
52H300	H300052	6W	-	52	210,21	208,84	-	90	182	85,7	100	24	11,80		
58H300	H300058	6A	-	58	234,47	233,09	-	90	207	85,7	100	24	12,20		
60H300	H300060	6A	-	60	242,55	241,18	-	90	215	85,7	100	24	13,00		
70H300	H300070	6A	-	70	282,98	281,61	-	100	255	85,7	100	28	16,50		
72H300	H300072	6A	-	72	291,06	289,69	-	100	263	85,7	100	28	19,00		
82H300	H300082	6A	-	82	331,49	330,12	-	100	304	85,7	100	28	18,00		
84H300	H300084	6A	-	84	339,57	338,20	-	100	312	85,7	100	28	20,00		
94H300	H300094	6A	-	94	380,00	378,63	-	120	352	85,7	100	28	25,50		
96H300	H300096	6A	-	96	388,08	386,71	-	120	360	85,7	100	28	27,00		
106H300	H300106	6A	-	106	428,51	427,14	-	120	401	85,7	100	28	27,90		
116H300	H300116	6A	-	116	468,93	467,56	-	120	441	85,7	100	28	28,50		
118H300	H300118	6A	-												